



A SENSE OF PLACE

From magical moments that arise out of nature's canvas at The Farm, to charmed gatherings at historic Piermont Cottage, it's about choosing the surroundings that speak to you. It's about choosing the very fabric that your memories will be woven into forever.



THE VENUES

OLD EDWARDS
INN *and Spa*

VENUES FOR A MAGICAL MOUNTAIN WEDDING EXPERIENCE

- Old Edwards Club
- The Farm at Old Edwards
- Hutchinson House
- Piermont Cottage
- Fairview House
- Half-Mile Farm
- Madison's Restaurant
- Old Edwards Private Wine Celler
- Rooftop Terrace
- Edwards Hall
- Trillium Terrace
- Springhouse
- Croquet Lawn at The Lodge

groupsales@oldedwardsinn.com
828.787.2610



OLD EDWARDS CLUB

*Ceremonies for up to 130 Guests
and up to 150 - 175 for Reception*

Rustically elegant architecture and interiors promote full relaxation and an incomparable air of carefree leisure. Floor to ceiling windows in the clubhouse afford panoramic views of the rolling landscape and the first tee. Perfect for a reception, ceremony, cocktail party or rehearsal dinner.

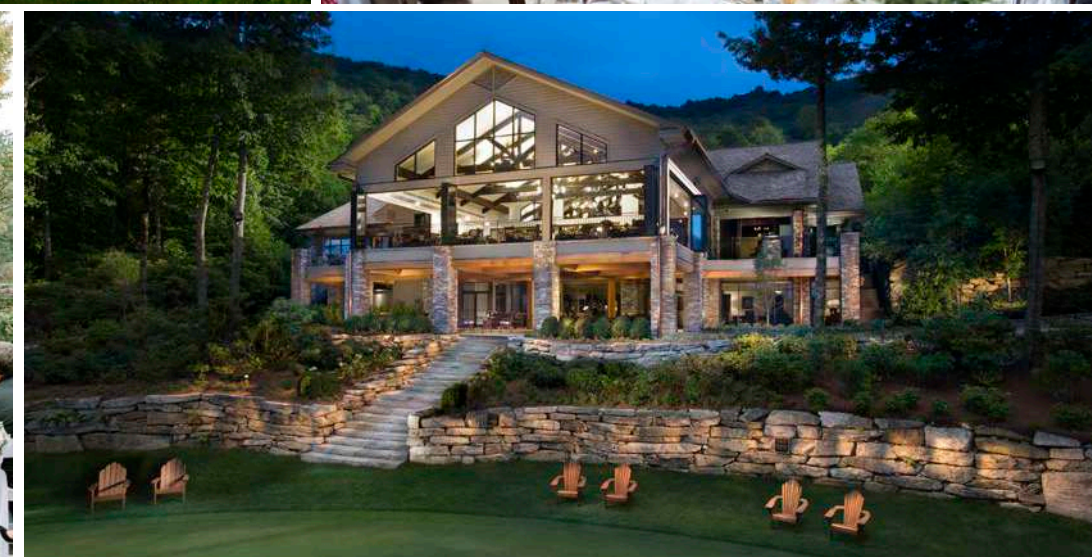

THE FARM at Old Edwards

THE FARM

For up to 275 guests

The Farm at Old Edwards spans 33 acres of lushly landscaped gardens. Native elements of wood and stone emerge from a landscape that is pure magic, a land where fairytales emerge... with happy endings, of course.

The Farm Includes:

- Elegantly Furnished Barn
- Spectacular Wood and Stone Glassed Pavilion
- The Orchard House
- The Orchard
- Traditional Farmhouse for the Bridal Party (features a 3 chair salon)
- Bridal Hut
- Trout Pond with Fountain and Bridal Bridge

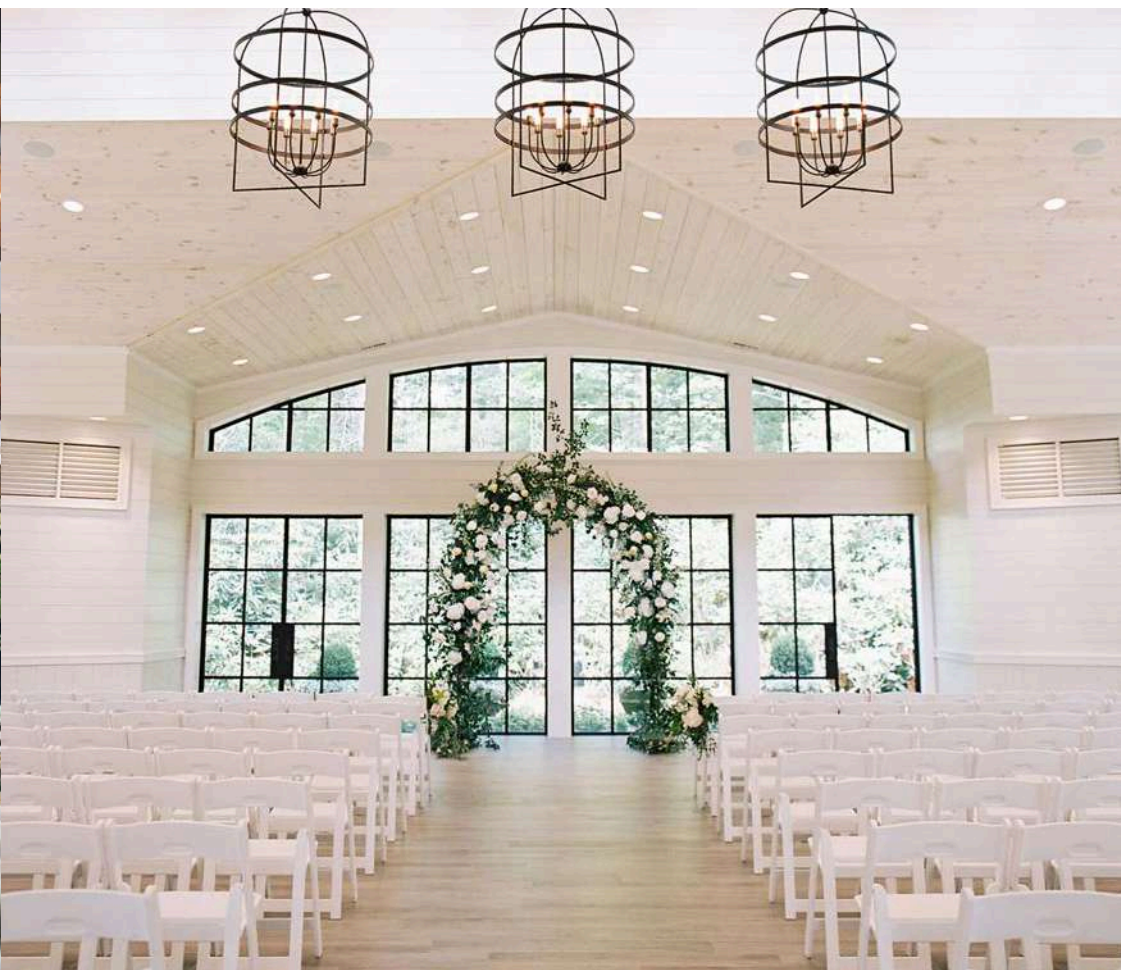

THE ORCHARD HOUSE

The new Orchard House features massive glass doors which can be opened to the lush English-style gardens. The interior features a pine wood ceiling with a pickled finish as well as timeless ship-lap wall detail. Custom iron doors grace the main entrance and allow for an expansive entry, while a custom iron arched transom window provides a dramatic backdrop which floods the space with natural light.

THE BARN & PAVILION

Heart pine flooring and a substantial stone fireplace provide a casually elegant setting. The 1,230 square-foot Barn may be utilized for the pre-reception area or for the wedding ceremony. From The Barn, barn doors open onto the 4,900 square-foot stone Barn Pavillion with space to accommodate up to 275 guests. This indoor/outdoor area is bordered by lush perennial gardens and covered arbors.



THE ORCHARD

Charming open space under a canopy of fruit trees — mostly pear and apple trees.

Ceremonies for up to 200 guests, and up to 275 for cocktail hour.



PIERMONT COTTAGE

Outdoor ceremonies for up to 130 guests.

Events for up to 180 guests.

Two Nights Accommodations Included

Piermont Cottage sleeps 8 and features 4 bedrooms, three-and-one-half bathrooms and a full kitchen. Also features a stunning ceremony lawn surrounded by a lush garden and a vast lawn for a tented reception.

Piermont Cottage is located in town within walking distance to Old Edwards Inn and is perfect for acoustic, non-amplified entertainment.



HUTCHINSON HOUSE

Events for up to 50 guests

Two Nights Accommodations Included

Hutchinson House is a four-bedroom farmhouse nestled among an enchanting wooded setting that includes nature walks, natural water features, gazebos and several garden spaces. It's perfect for acoustic, non-amplified entertainment. Built in 1878, this historic property is located one block east on Main Street from Old Edwards Inn and Spa, providing guests with walking access to all the shopping, dining and culture that Highlands has to offer.



HALF-MILE FARM

*For up to 100 guests May-October
34 rooms, full buy-out required.*

Surrounded by fourteen acres of fields, forests and streams, Half-Mile Farm graces the land with beautiful patios, courtyard and grounds, a heated pool, a forest trail, a six-acre lake and two stocked ponds. An expansive green lawn cascades down a long hill to the private lake creating a picture perfect wedding scene. Inside, sumptuous bedding, comfy robes and many luxury touches welcome your guests.

Your guests and family can book a relaxing massage in our Spa Serenity Suite before your big day and enjoy complimentary breakfast served each morning.

FAIRVIEW HOUSE

*Sleeps up to 25 guests.
Events for up to 50 guests.*

This fully renovated historic home with ten private bedrooms and nine full baths is just three blocks from Main Street. It the perfect addition to your wedding weekend by being able to keep your bridal party or family together in one place.

The home has a fully equipped gourmet kitchen featuring top of the line appliances, an outdoor BBQ station and a stand-alone beverage station.

Relax with friends and family in the large great-room with fireplace, cozy parlor/library with fireplace, media room, covered patio with fireplace, wrap-around rocking chair porch and second story wrap-around balcony overlooking the property.





MADISON'S RESTAURANT

For bridal luncheons or dinners.

The Four-Diamond Madison's restaurant is known for some of the best dining in Western North Carolina. The talented culinary team hand crafts each dish with farm-to-table, sustainable ingredients to bring out the most abundant flavors nature has to offer. Madison's Wine Spectator list features an exceptional selection.



Hummingbird Lounge



EDWARDS HALL

For rehearsal dinners, farewell brunches, bridesmaid luncheons, banquets or private dining for up to 125 guests.

Centrally located on property, the Edwards Hall hosts private dining events in its four event rooms including the Trillium Terrace.



TRILLIUM TERRACE

Up to 40 for seated events, and up to 60 for cocktail parties.

Trillium Terrace is intimate but centrally located on property. It has a lawn courtyard setting with a beautiful stone wall on one side covered in white hydrangeas.



PRIVATE WINE CELLAR

For bridal luncheons and private dinners of up to 12 guests.

The Wine Cellar provides an intimate social setting with magnificent Old-World décor and friendly but impeccable service. Share an unforgettable evening with up to 12 close friends.

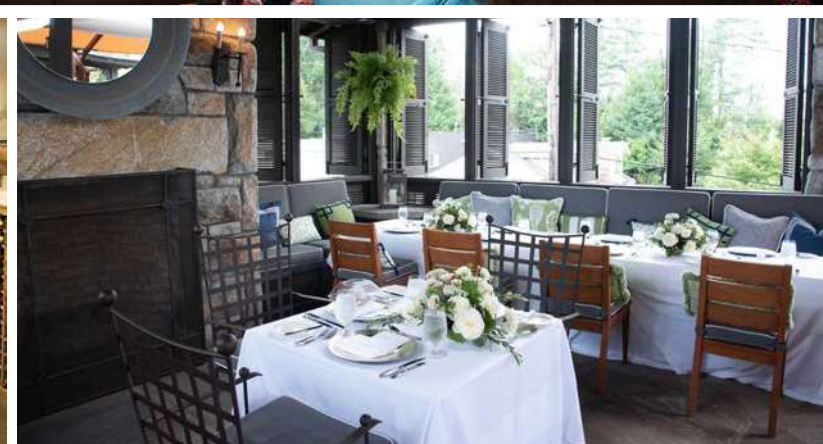

ROOFTOP TERRACE

For bridal luncheons of up to 24 guests, and cocktail parties of up to 40 guests.

One of the best views and intimate spots at Old Edwards Inn and Spa, the Rooftop Terrace is located at the Historic Main Inn. Charming décor of wood and stone surround you in this magical spot.





SPRINGHOUSE

*For welcome parties,
rehearsal dinners and farewell brunches.
For up to 110 guests for dinner,
and up to 150 for cocktail parties.*

With its large floor plan
and expansive bar, the Springhouse
is the perfect setting for
your post or pre celebrations.



THE DETAILS



ELEGANCE AND SPLENDOR

Each wedding designed with the team at Old Edwards Inn and Spa is as unique and special as the couple to be wed. Discover the elegance and splendor of a wedding in the mountains.

The details here will cover policies, wedding room blocks, vendors and other information for a harmonious flow to your special event.



OUTDOOR EVENTS

In order to provide the highest level of service, we must require the use of a tent at all outdoor venues. In the event that it should rain before or during your wedding—your settings, decorations, cake, entertainment and most of all you and your guests are protected.

COMPLIMENTARY SERVICES FOR YOUR WEDDING

Event Space, Set-up and Breakdown
Folding Garden Chairs
Fine White Linens and Napkins
Elegant Place Setting including China, Choice of Silver or Gold Charger, Silver and Stemware
Assistance in Customizing Menu and Bar Selection
Guidance and Facilitation throughout the Planning Process

ADDITIONAL SERVICES AND AMENITIES

Accommodations at Old Edwards Properties
Personal Assistance from our Spa Sales Coordinator
Personal Assistance from our Head Golf Professional
World Class Farm-to-Table Madison's Restaurant
Acorns Boutique and Acorns on Church Bridal Registry
Activities and Excursions
Multiple on-site Venues for Welcome Parties, Bridal Luncheons, Rehearsal Dinners and Farewell Brunches

TRANSPORTATION

Resort van and/or Executive Coach transportation can be arranged for your guests staying at Old Edwards Inn to be transported to and from your venue. Please arrange this with your Sales Manager. Additional transportation can be arranged through our recommended vendors. Groups of 150 or more will need to arrange for additional transportation for the events at the Farm. Events at Half-Mile Farm require transportation services for all guests.

SHIPPING AND RECEIVING OF PACKAGES

Prior to shipping any boxes to Old Edwards Inn for your event, please contact your Sales Manager regarding instructions and proper labeling of boxes. All incoming boxes will incur a \$5.00 plus tax per box handling fee. Any outgoing boxes will incur a \$5.00 per box plus tax handling fee in addition to the shipping charges.

Due to postal stipulations, there is not a 10 am delivery, only a 4 pm guarantee. No deliveries occur on Saturday or Sunday.

GROUP ACCOMMODATIONS

Old Edwards is pleased to offer group blocks for our wedding parties based on availability, guest count and food and beverage minimums. We will hold a block of rooms for your wedding as outlined in your Group Rooms Agreement.

If you wish to assign the rooms, you must pay a first night deposit, as well as provide a rooming list upon signing the agreement for any special guests (such as family members) within the room block.

Guestroom Reservation Wedding inserts are available upon request to assist you in informing your guests about the reservation process.

The cut-off date for reservations is one month prior to the wedding. Any changes or additions made to the final rooming list after the cut-off date must be approved by your Sales and Catering Manager.

Individual reservations will be charged for the first nights stay at the time of reservation and cancellation penalties do apply. After the cut-off date, guest rooms are available on a space available basis and at the most current published rack rates.

Contact our Reservations Specialists at 866-526-8008

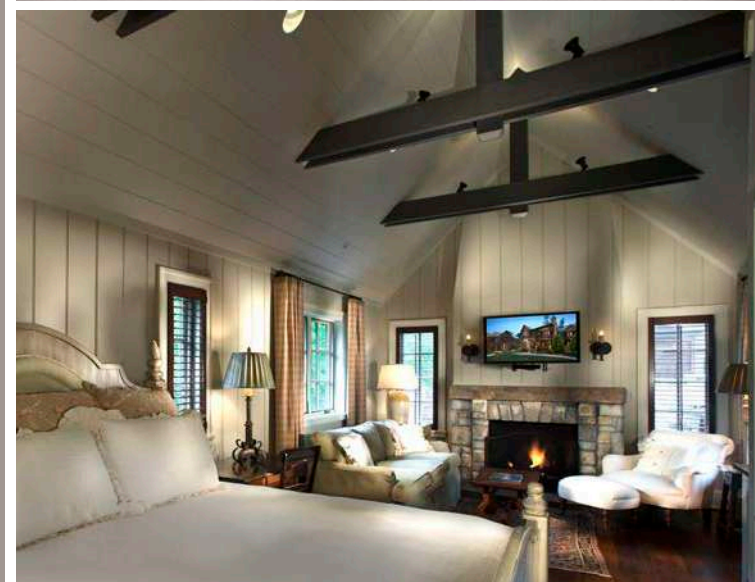

Full Piermont Cottage map follows.

OLD EDWARDS INN and Spa



- Bar
- Dining
- Parking
- Restrooms

Check-in Locations

If you need assistance during your stay, please stop by a check-in location, or call our concierge at 828-526-8008.

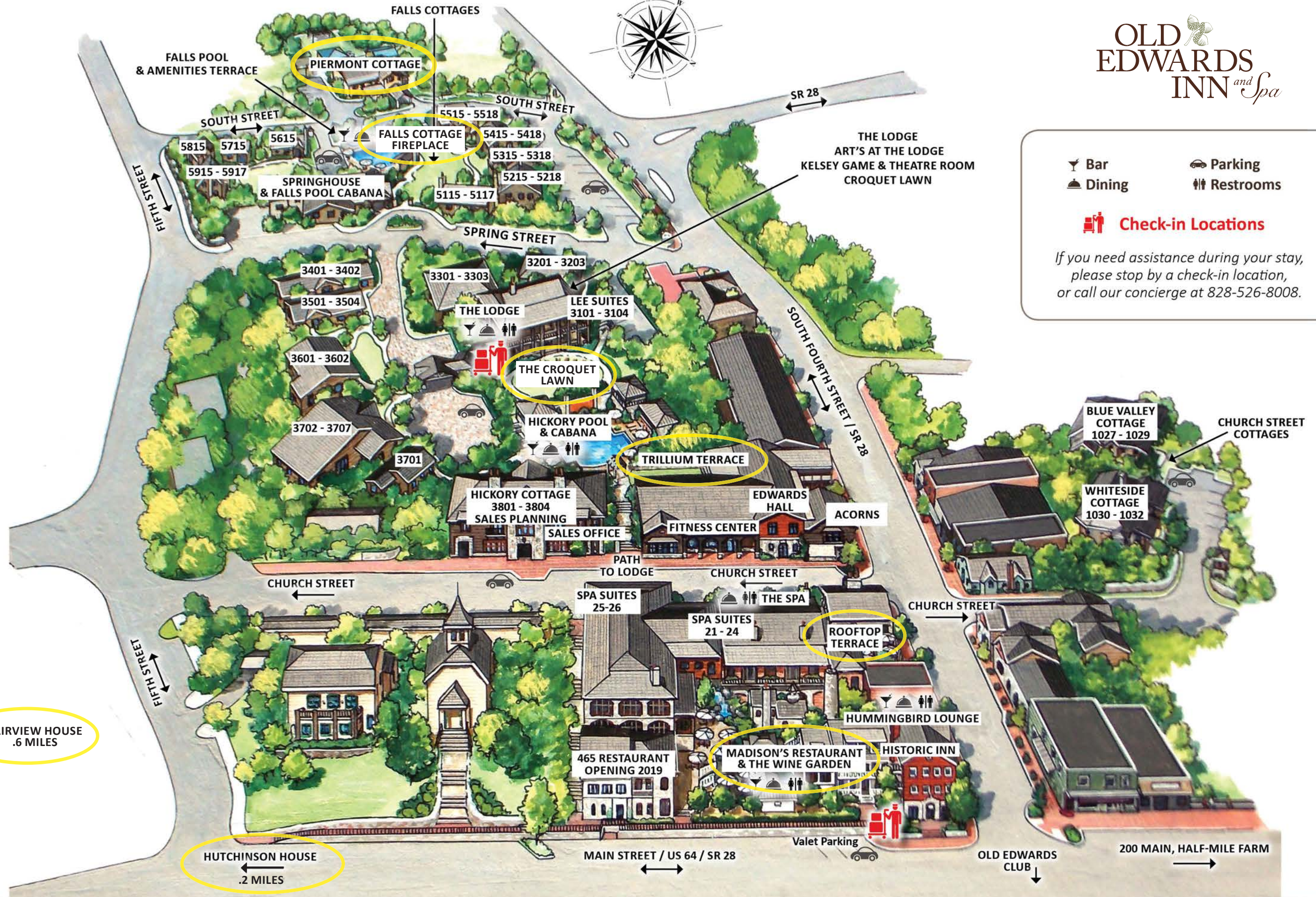

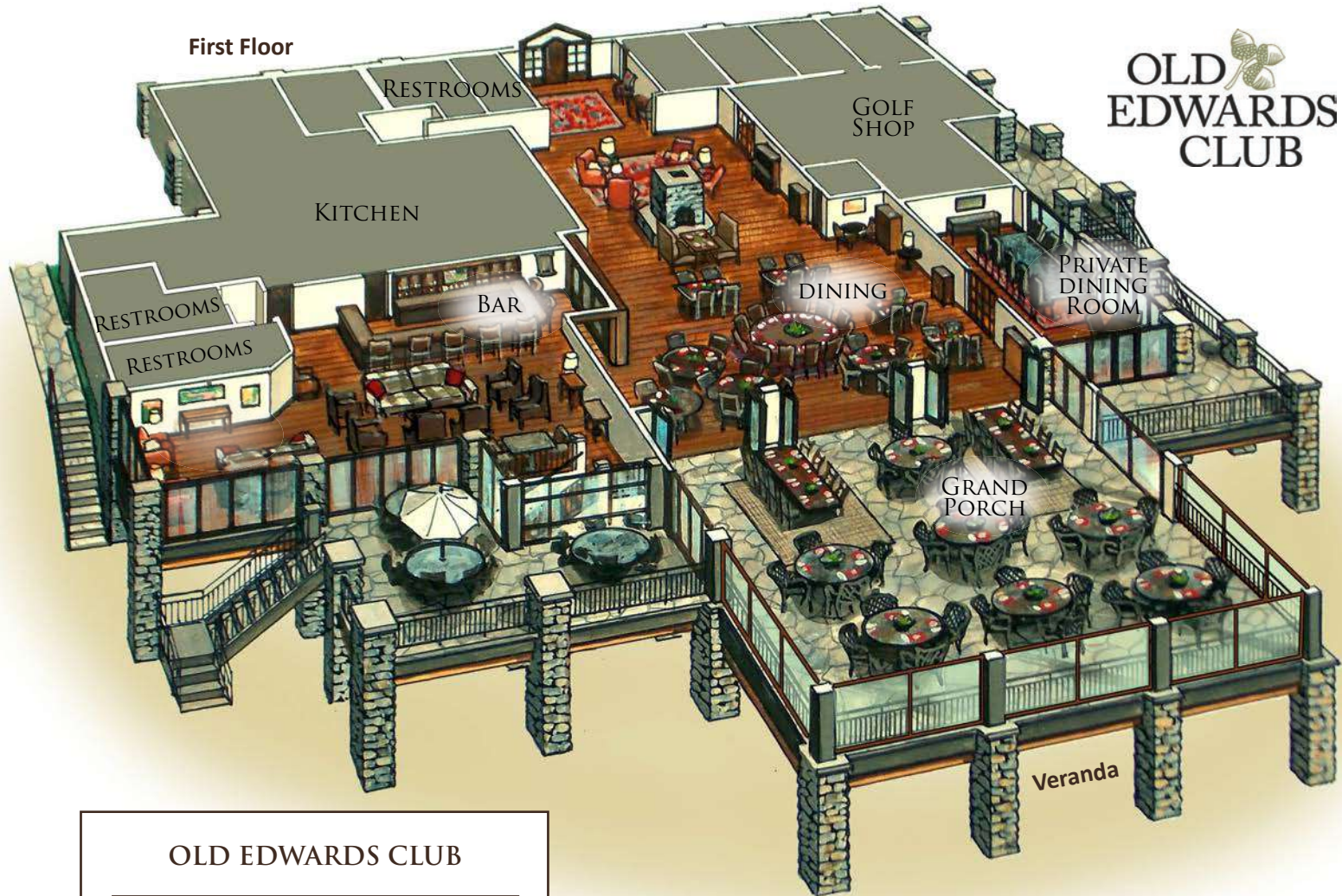

OLD EDWARDS CLUB

OLD EDWARDS CLUB		
GRAND PORCH	48' X 42'	2016 SQ. FT.
DINING ROOM	44' X 42'	1848 SQ. FT.
PRIVATE DINING ROOM	30' X 16'	480 SQ. FT.
BAR	32' X 10'	320 SQ. FT.
BAR SEATING	34' X 12'	408 SQ. FT.
VERANDA	48' X 42'	2016 SQ. FT.
CHIMNEY TERRACE		1600 SQ. FT.

OLD EDWARDS INN and Spa

THE FARM AT OLD EDWARDS		
BARN	41' 2" x 35' 4"	1230 SQ. FT.
BARN PAVILION	66' 4" x 73' 6"	4900 SQ. FT.
ORCHARD HOUSE	47' x 57'	2679 SQ. FT.

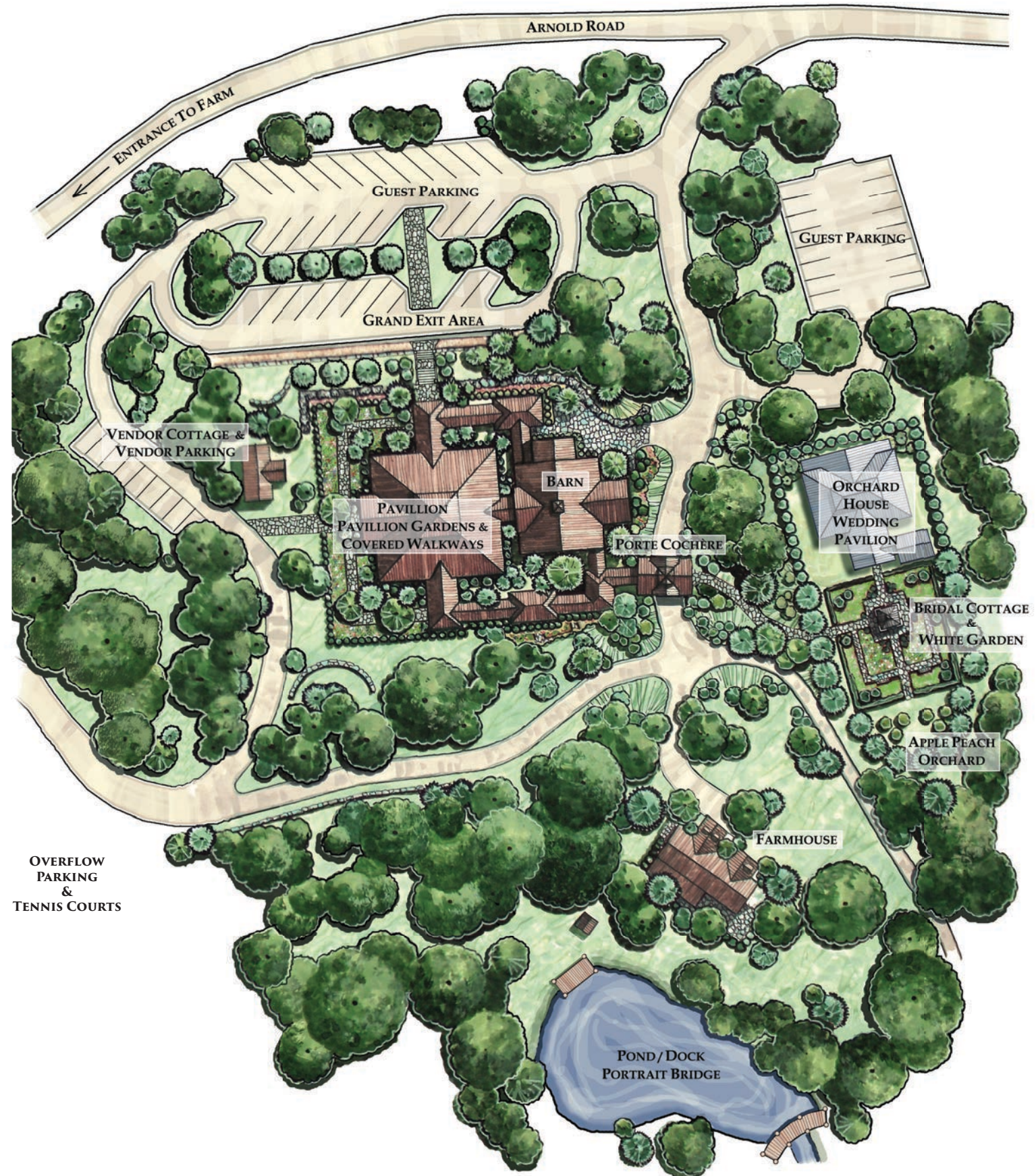

OVERFLOW PARKING & TENNIS COURTS



Planters



The Piermont Cottage

GRAND LAWN	140' X 90'	12,600 S.F.
CERAMONY LAWN	50' X 60'	3,000 S.F.
STONE TERRACE	30' X 45'	1,350 S.F.
BRIDE'S HOUSE	16' X 16'	256 S.F.

OLD EDWARDS INN and Spa

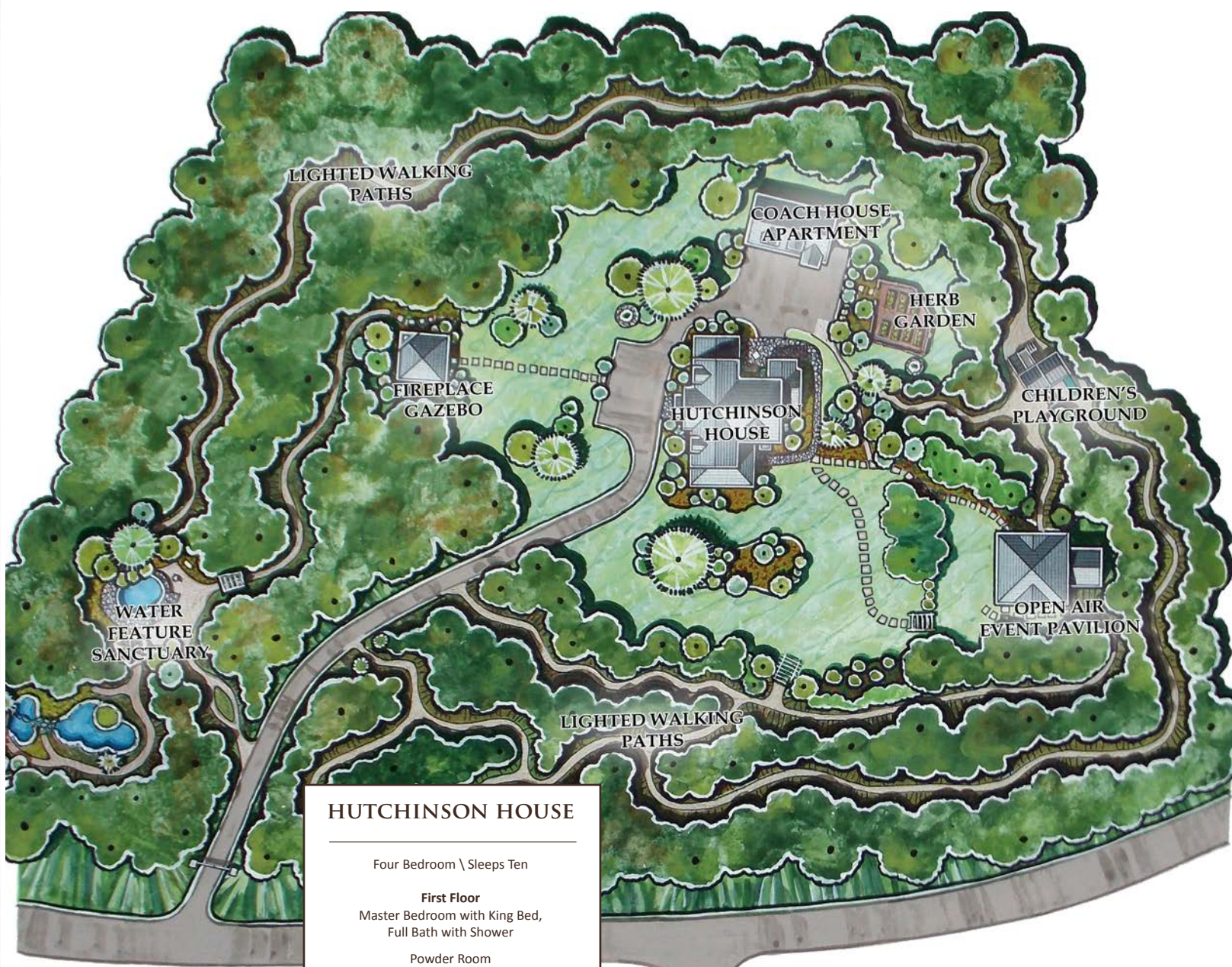

HUTCHINSON HOUSE

Four Bedroom \ Sleeps Ten

First Floor

- Master Bedroom with King Bed, Full Bath with Shower
- Powder Room
- Kitchen and Dining room

Second Floor

- Bedroom One with Two Twin Beds
- Bedroom Two with Two Queen Beds
- Bedroom Three with One King Bed
- Powder Room
- Full Bath with Clawfoot Bathtub and Shower Surround

Coach House Apartment

- One Trundle Bed (Two Twin)
- Full Bath with Shower
- Kitchenette

HUTCHINSON HOUSE

EVENT PAVILION	30' X 30'	900 SQ. FT.
PAVILION ALCOVE	12' X 12'	144 SQ. FT.
FIREPLACE GAZEBO	20' X 20'	400 SQ. FT.

HALF-MILE FARM

A Luxury Country Inn by Old Edwards

214 Half Mile Drive
Highlands, NC 28741
halfmilefarm.com
855-271-7246

See back for room locations.

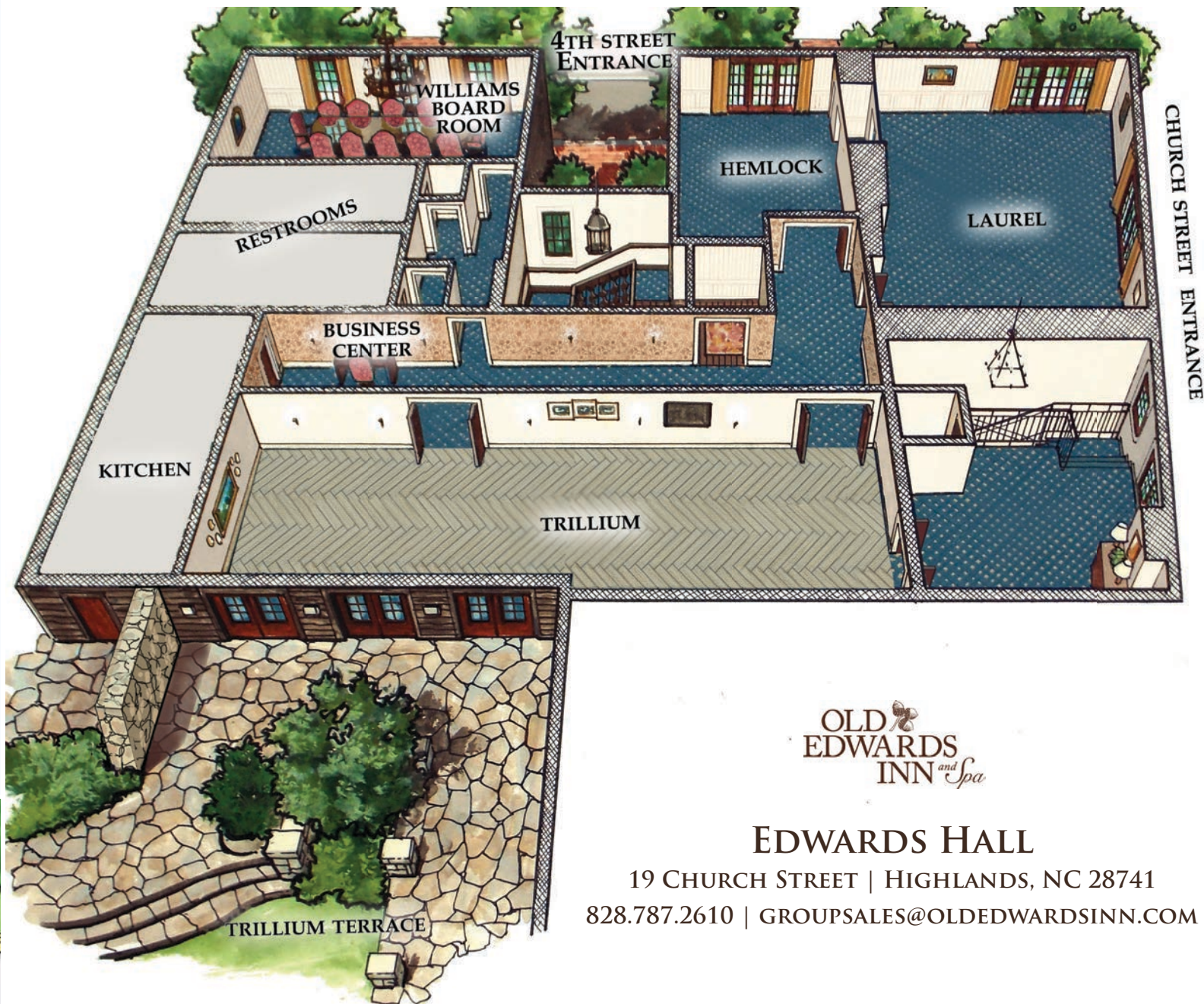

EDWARDS HALL

19 CHURCH STREET | HIGHLANDS, NC 28741
828.787.2610 | GROUPSALES@OLDEDWARDSINN.COM

Meeting Space	Total Sq Ft	Total Size	Ceiling	Theatre Style	Classroom Style	U-Shape	Hollow Square	Reception	Banquet	Notes
TRILLIUM	1176	21 X 56	8	130	80	n/a	n/a	125	90	Built in AV with dropdown screen
LAUREL	1092	42 X 26	10	115	70	22	26	115	80	Built in AV with dropdown screen
HEMLOCK	532	28 X 19	10	60	36	12	14	58	40	
WILLIAMS BOARD ROOM	646	19 X 34	10	CONFERENCE STYLE FOR 22					Built-in AV with dropdown screen	
TRILLIUM TERRACE	Seating For Up To 50									



OLD
EDWARDS
INN *and Spa*

For additional wedding photos at Old Edwards
follow us on Instagram @oldedwardsevents

2019 U.S. News & World Report
#3 Hotel in North Carolina

2018 Travel + Leisure World's Best Awards
#6 Resort Hotel in The South

2018 Conde Nast #17 Top Hotels in the South

2018 U.S. News & World Report
#2 hotel in North Carolina

