



Experience **CAMP LUCY**

CAMP  **LUCY**

A TEXAS WINE COUNTRY RESORT

Welcome to Camp Lucy

Home to several one-of-a-kind wedding venues and a collection of support services that will make your wedding as memorable as it is easy to plan, Camp Lucy is the premier destination for celebrations of love in the Texas Hill Country. This breathtaking 282 acre resort property, nestled within the rolling hills of Dripping Springs, was originally established as a wedding venue and has garnered national acclaim thanks to our impeccably maintained venues, luxury accommodations and beautiful location. Our overnight guests will also have access to onsite activities, resort pool and fine dining restaurant, Tillie's. With stunning venues, luxurious amenities and exemplary customer service, Camp Lucy has everything you need to make your wedding truly special for you and your guests.



INCLUDED IN YOUR CAMP LUCY EXPERIENCE

- Camp Lucy's expert Account Manager to curate your menus and on-site experience
- 2-hour engagement or bridal photography session (at Camp Lucy with your chosen photographer)
- Hospitality Suites on the day of your event
- 10-hour time block at your venue
- Signature dining tables, chairs for reception, and outdoor ceremony chairs
- Additional tables included: 6 cocktail tables, 2 48" round tables
- Sit back and relax while we set-up and tear down your event
- Security Officer
- Signature linens in choice of: Ivory, Beige or Navy
- Signature dinner napkins in choice of: Ivory, Beige or Navy
- White French Knot dinner and dessert plates
- Silver Flatware
- Crystal Glassware





(1) Anastasia Strate Photography | (2) Mint Photography | (3) ML Photo & Film | (4) Ashleigh Amoroso Photography | (5) Taylor Elizabeth Photography | (6) Kelsie EmmPhotography |

Meticulously designed and built with heart, Camp Lucy's original and most versatile venue, Ian's Chapel, provides unlimited potential for hosting your dream ceremony and reception with a variety of offerings. This space perfectly blends together heritage buildings, like the chapel, a 200-year-old French Colonial church with modern conveniences, such as a pair of luxurious hospitality suites, to create a celebration that's as unique as your love.

Capacity: 300

**capacities may vary based on room set-up*



FACILITIES:

- Chapel
- Pavilion
- Brick Paved Patio
- Stone Arch Overlook
- Great Lawn
- Events Hall
- Two Hospitality Suites
- Private Deck
- Ample Parking

STARTING PRICE:

\$9,500

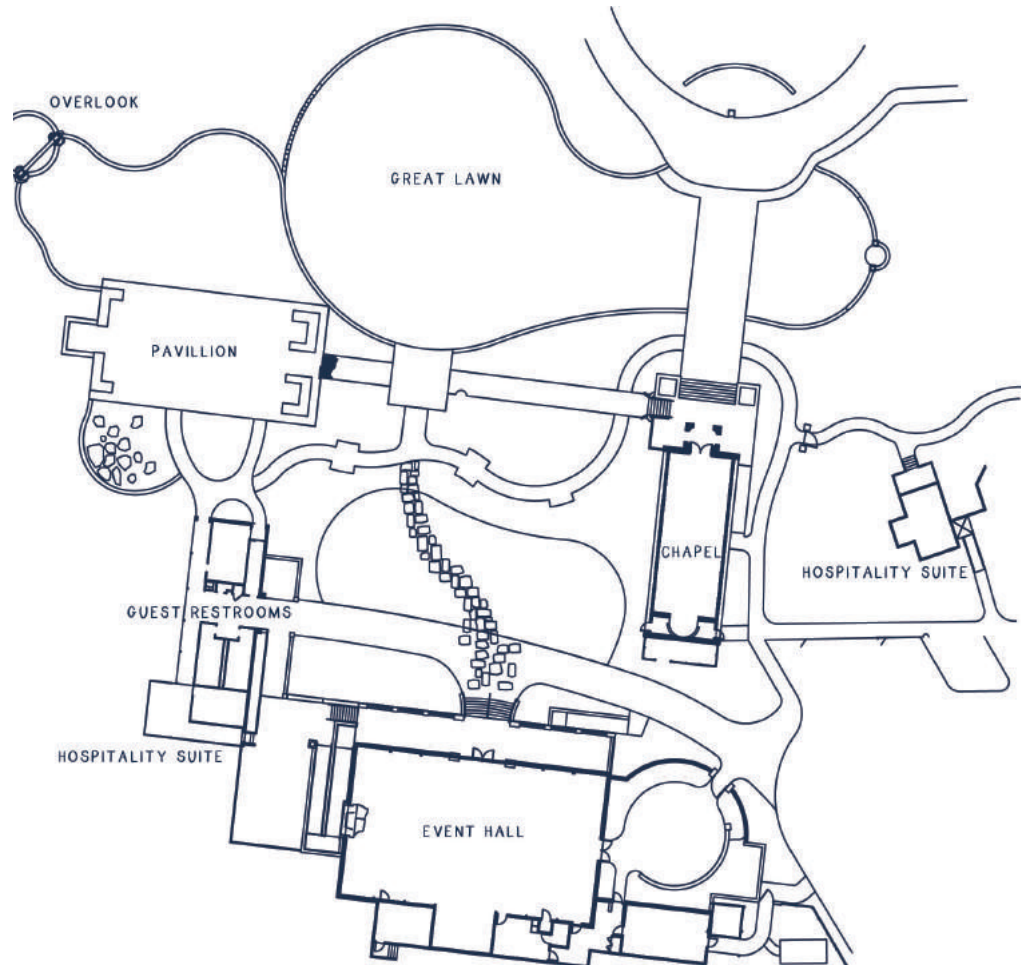



(1) Studio Uma Photography | (2) CarolinesCollective Photography | (3) SMS Photography | (4) Benjamin Garrett Photography | (5) Jenny DeMarco Photography | (6) Ashleigh Amoroso Photography

A beautiful grove of ancient oak trees and twinkling lights surrounds this outdoor ceremony space creating one of the most gorgeous wedding settings imaginable. With an impressive timber-framed formal reception hall that's large enough to host as many as 350 guests, the beauty of Sacred Oaks isn't limited to the outdoors either. The Great Hall includes a pair of well-appointed hospitality suites, built-in bar and private patio area.

Capacity: 350

**capacities may vary based on room set-up*



FACILITIES:

- Great Hall
- Tree-Covered Ceremony Site
- Great Lawn
- Bell Tower
- Two Hospitality Suites
- Ample Parking

STARTING PRICE:

\$9,500

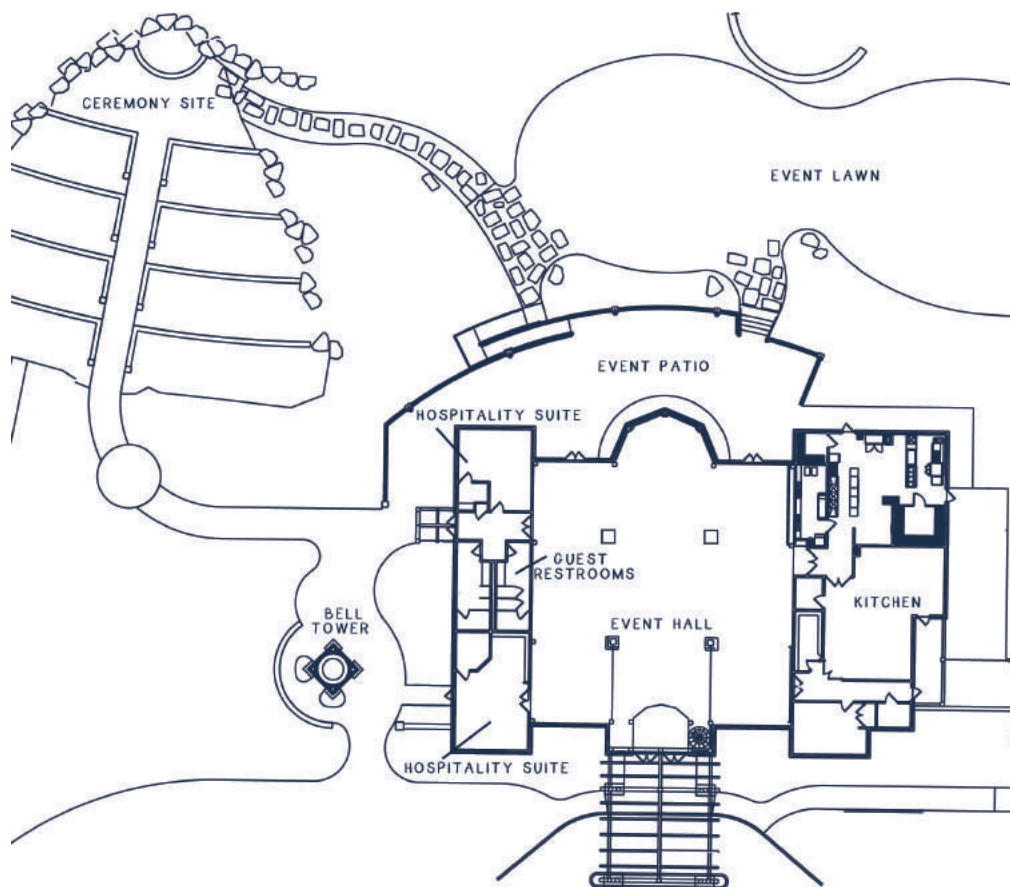



(1-5) Lacey Lynn Seymore Photography (6) AlGawlik Photography | (7) Amy Cutter Photography (8) (9) Amy Jean Photography

Drink up the romance of the Texas Wine Country at our newest venue. Nestled within our working vineyard, this venue space includes a permanent, 88-foot Savannah Sperry Tent, breathtaking bistro-lit aisle and tree-covered ceremony site. Relish in the magic of an outdoor vineyard wedding with the luxury of reception amenities including two private hospitality suites.

Capacity: 150+

**capacities may vary based on room set-up*



FACILITIES:

- Savannah Sperry Tent
- Ceremony Site
- Restrooms
- Two Hospitality Suites
- Deck
- Ample Parking

STARTING PRICE:

\$6,500

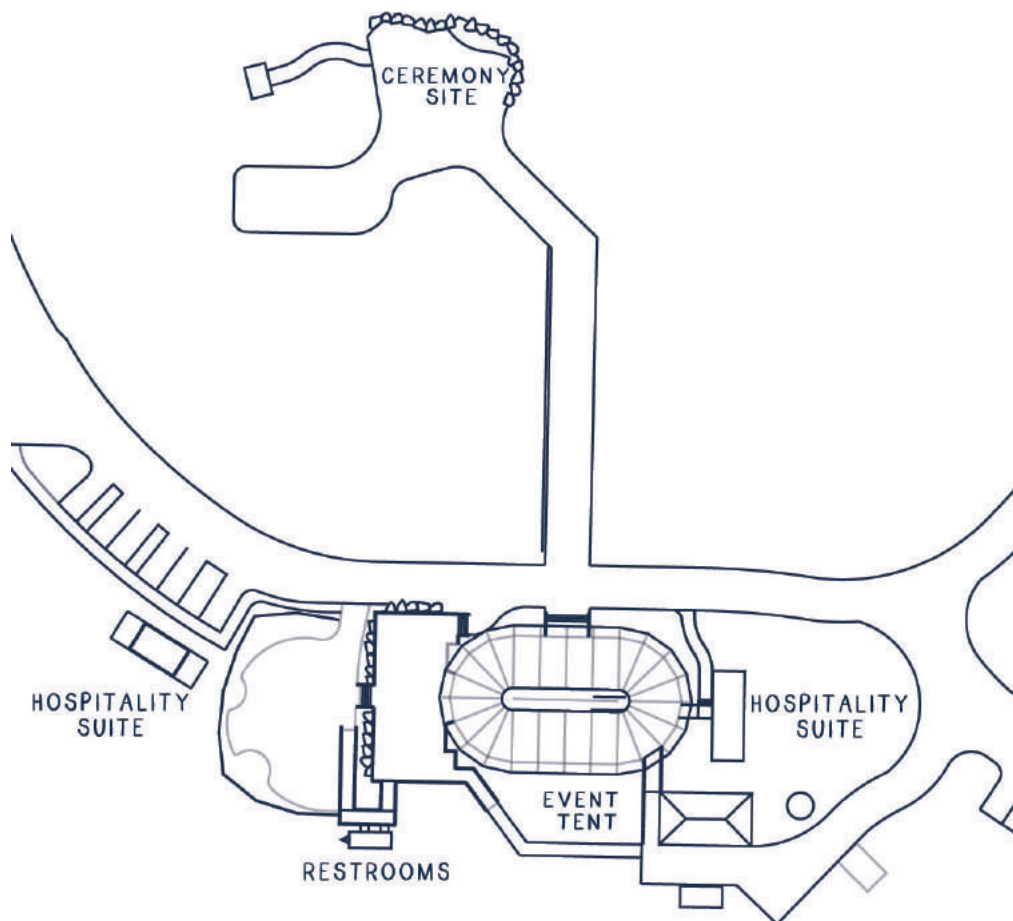



Camp Lucy's Food & Beverage program mixes the refined taste of an A-List event with the warmth and creativity of the Texas Hill Country. We pride ourselves on exceptional presentation, world-class service and a unique dining experience no matter the size of your event.

Under the leadership of Executive Chef, Meredith Shaffer, our team is prepared to help you curate the most delicious and memorable day for you and your guests.



BUFFET MENU:

\$85 Per Guest

Includes your choice of:

2 Entrees

2 Signature Sides

2 Salads

Artisan Bread and Butter
Water, Ice, Iced Tea, Coffee

FAMILY-STYLE MENU:

\$95 Per Guest

Includes your choice of:

2 Entrees

2 Signature Sides

2 Salads

Artisan Bread and Butter
Water, Ice, Iced Tea, Coffee

PLATED MENU:

\$105 Per Guest

Includes your choice of:

1 Entree with sides

1 Salad

Artisan Bread and Butter
Water, Ice, Iced Tea, Coffee

BEER + WINE PACKAGE:

\$35 Per Guest

SIGNATURE BAR PACKAGE:

\$50 Per Guest

PREMIUM BAR PACKAGE:

\$55 Per Guest

For detailed list of menus, bar package inclusions, specialty bars and more, please view our full Food & Beverage packet.



VISTA



ESTATE



JR. ESTATE SUITE



TERRACE SUITE



ESTATE



ENGLISH SUITE



LUCY'S COTTAGE



TREETOP



CREEKSIDE COTTAGE

CREEKSIDE COTTAGE

Accommodates up to 10 guests

- Full kitchen & dining area
- Master room- 2 queen beds
- Guest room- 2 XL twin beds
- Corner room- 1 queen bed
- Queen sleeper sofa

LUCY'S COTTAGE

Accommodates up to 10 guests

- Full kitchen & dining area
- Master room- 1 king & 1 full bed
- Guest room- 1 king bed
- Corner room -2 XL twin beds
- Queen sleeper sofa



ESTATE DOUBLE QUEENS (7)

Accommodates up to 4 guests

** Two ADA-Compliant rooms accommodate up to 6 guests with sofa bed*

- Kitchenette
- Hand carved stone tubs

VISTA DOUBLE QUEENS (4)

Accommodates up to 6 guests

- Kitchenette
- Ravine-overlook balcony
- Step-down living area + sofa bed

TREETOP DOUBLE QUEENS (2)

Accommodates up to 4 guests

- Kitchenette
- Private balcony

ESTATE KINGS (7)

Accommodates up to 2 guests

- Kitchenette
- Hand carved stone tubs

VISTA KINGS (8)

Accommodates up to 4 guests

- Kitchenette
- Ravine-overlook balcony
- Step-down living area + sofa bed

TREETOP KINGS (8)

Accommodates up to 2 guests

- Kitchenette
- Private balcony

JUNIOR ESTATE SUITE

Accommodates up to 4 guests

- Kitchenette
- Private living area
- King size bed
- Queen sleeper bed

TERRACE SUITE

Accommodates up to 2 guests

- Kitchenette
- Two private patios
- Luxury stone tub
- Private living area + fireplace

ENGLISH SUITE

Accommodates up to 2 guests

(ADA-Compliant Suite)

- Kitchenette
- Private patio
- Luxury stone tub
- Private living area + fireplace
- Outdoor rain shower

Stedman Hall



Walking-distance from all guest rooms, this multi-function event space is the perfect location to gather.

From rehearsal dinners, a farewell brunch, or additional hospitality space, Stedman Hall provides a flexible and beautifully-appointed setting for all of your celebrations.

Capacity: 45

**capacities may vary based on room set-up*

FACILITIES:

Blue Farm Tables
60" Round Tables
6' Tables, 8' Tables
Chiavari chairs
Lounge Furniture
Breakout Meeting Spaces
On-Site Kitchen
Private Patio/ Deck



STARTING PRICE:

\$2,250

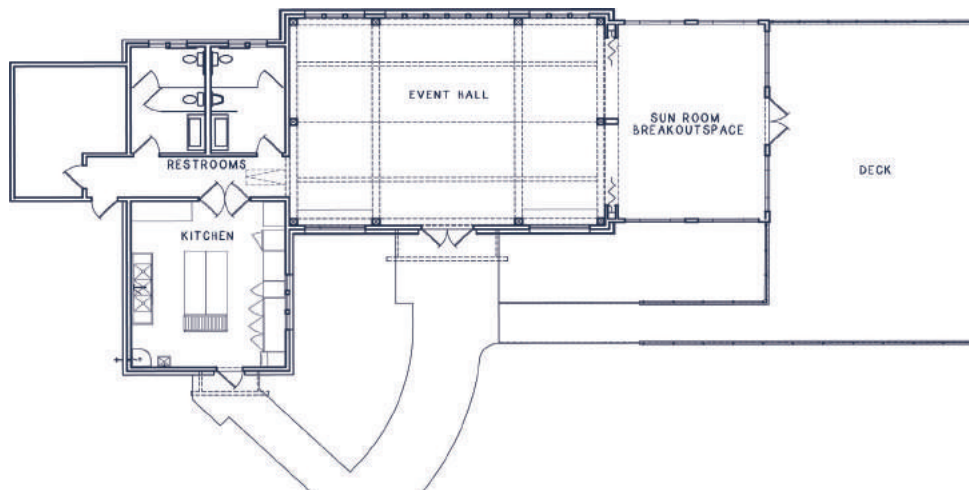



ACTIVITIES

With a diverse collection of happenings and guest activity programs, there is always something going on at Camp Lucy for guests of any age and interest. From yoga to archery, we offer a wide variety of on-property entertainment to ensure an experience like none other for you and your guests.

RESORT POOL

It's no mirage! The resort pool at Camp Lucy offers one of the most luxurious ways to enjoy the Texas Wine Country with swim-up bar and food options from the property's fine dining restaurant, Tillie's. Swim, sunbathe or sip your cares away at the Camp Lucy resort pool.



VINEYARD

Enjoy the best of the Texas Wine Country at our 4 -acre working vineyard. Since our first harvest in 2014 we have expanded to growing enough grapes (which we hand-pick every summer) to produce 4 varieties of Camp Lucy wine. Stroll through the vineyard and/or sip on a glass of our very own vino!

TILLIE'S RESTAURANT

In addition to some of the most beautiful wedding venues in Texas, Camp Lucy is home to Tillie's, an upscale restaurant and bar serving American Nouveau and updated Texas offerings. Tillie's built its menu by taking what's familiar and infusing it with an array of innovative international flavors, creating a new set of rules for cuisine in Central Texas. Private dining space available for parties of 8-20 guests.

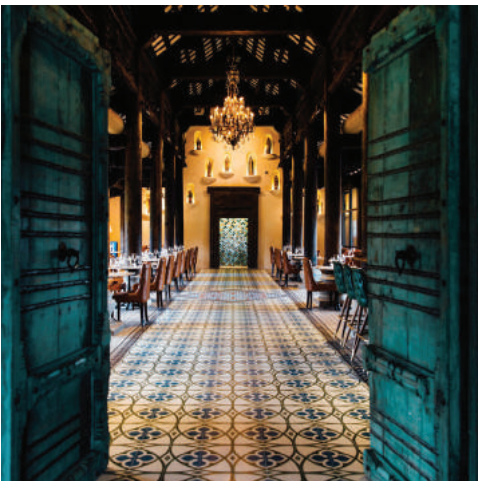

3509 CREEK ROAD | DRIPPING SPRINGS, TX | 78620



EVENTS@CAMPLUCY.COM

512.894.4400



@camplucyoncreek